



Vehicle Restraint Owner's Manual

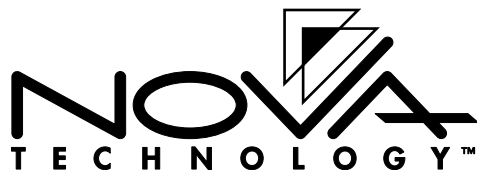
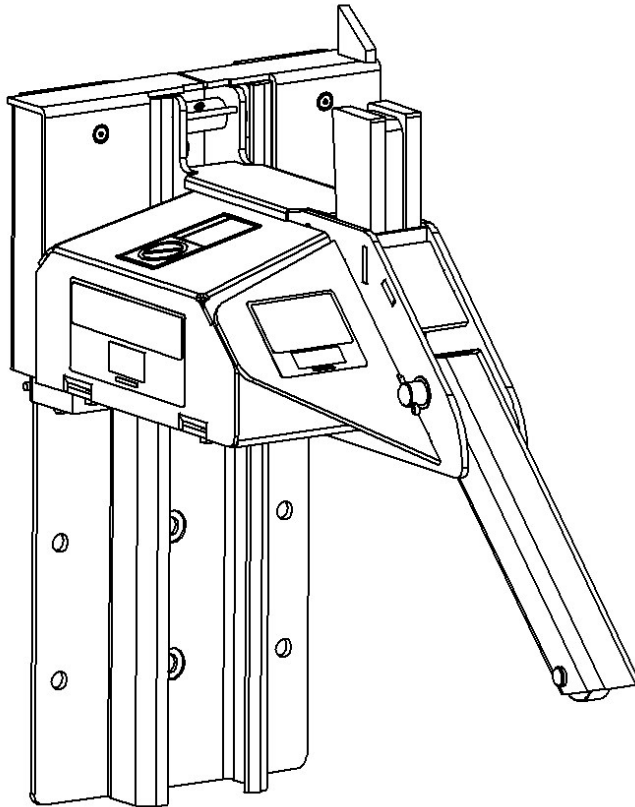

TABLE OF CONTENTS

SAFETY WARNINGS	3
COMPONENTS DESCRIPTION	4
OPERATING PROCEDURES	5
ROUTINE MAINTENANCE	9
TROUBLESHOOTING	11
CONTROL HARNESS	13
ELECTRICAL SCHEMATIC	14
OUTSIDE LIGHT BOX WIRING	15
PARTS	16
NOTES	21
WARRANTY.....	23

Nova Technology engages in ongoing product development and reserves the right to make changes and improvements to any of the products described in this document without prior notice.

SAFETY WARNINGS

You will find the safety alerts DANGER, WARNING, CAUTION or NOTICE used throughout this manual. Their meaning is listed below:

 DANGER
This is the highest level statement. Failure to follow the listed instructions will most likely result in death or serious injury.

 CAUTION
The statements used with this level of warning deal with a safe operating procedure. If the procedure is ignored the possibility of personal injury may exist.

 WARNING
This is a statement of serious hazard. Failure to follow the listed instructions could place the individual at risk of death or serious injury.

NOTICE
NOTICE is used to draw attention to a procedure that needs to be followed to prevent machine or property damage.

DO NOT OPERATE THIS PRODUCT UNTIL YOU HAVE READ AND UNDERSTAND THE SAFETY PRACTICES, WARNINGS AND OPERATING INSTRUCTIONS CONTAINED WITHIN THIS MANUAL. IMPROPER USE OF THE LOCK-UP™ VEHICLE RESTRAINT COULD RESULT IN DEATH OR SERIOUS INJURY.

If the Lock-Up™ vehicle restraint does not operate properly using the procedures in this manual, BE CERTAIN TO CHOCK THE VEHICLE WHEELS BEFORE LOADING OR UNLOADING. Contact NOVA or your local representative for service.

COMPONENTS DESCRIPTION

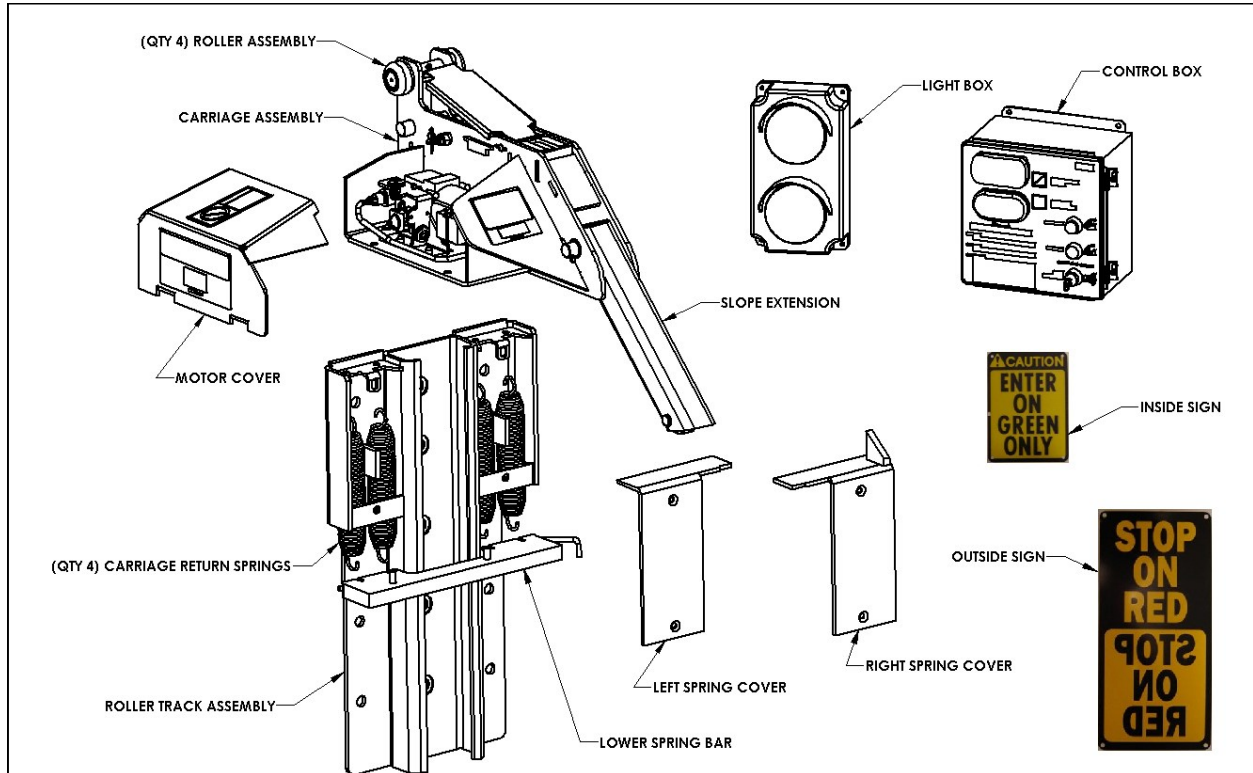

Figure A—Lock-Up™ Components Description

OPERATING PROCEDURE



WARNING

Before loading or unloading a vehicle at your loading dock while using a Lock-Up™ vehicle restraint, always visually inspect to be sure that the restraint is engaged with the Rear Impact Guard (RIG). If the restraint is still not engaged after backing the trailer firmly against the dock bumpers, secure the trailer by other means.

Be sure that the area around the RIG assembly is clear of obstructions.

Always operate the Lock-Up™ vehicle restraint from the top of the dock.

Inspect all restraint lights daily to make certain they work properly.

Perform maintenance on restraints in accordance with Maintenance on page 11 of this manual.

Lock-Up™ vehicle restraints should be operated only by authorized personnel who have read and understand the Owner's Manual.

If you have questions, Call your local representative or NOVA at (800) 236-7325.

FAILURE TO FOLLOW THESE PROCEDURES COULD RESULT IN DEATH OR SERIOUS INJURY.

Stored Position / Restraint UNLOCKED

Barrier is in the STORED position. Inside light is flashing red alerting forklift operator unsafe condition exists. Outside light is flashing green alerting truck driver it is safe to back in.

Refer to Figure B.

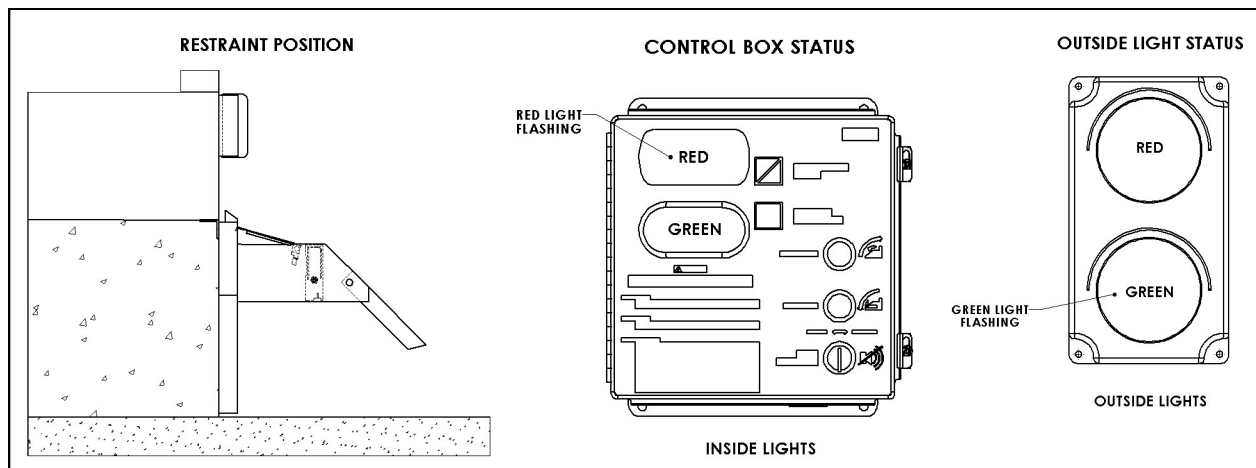

FIGURE B—STORED POSITION

OPERATING PROCEDURE *continued*

RESTRAIN Button Pressed - Restraint ENGAGING

Trailer has backed into loading dock and is parked firmly against dock bumpers. Barrier rises from stored position to engage RIG. Outside light is flashing red alerting truck driver not to move. Refer to Figure C.

If horn sounds, proceed to FAULT, otherwise proceed to Restraint ENGAGED.

CAUTION

If trailer can not be restrained due to a lift gate or other obstruction that could become damaged, proceed to **VERRIDE**.

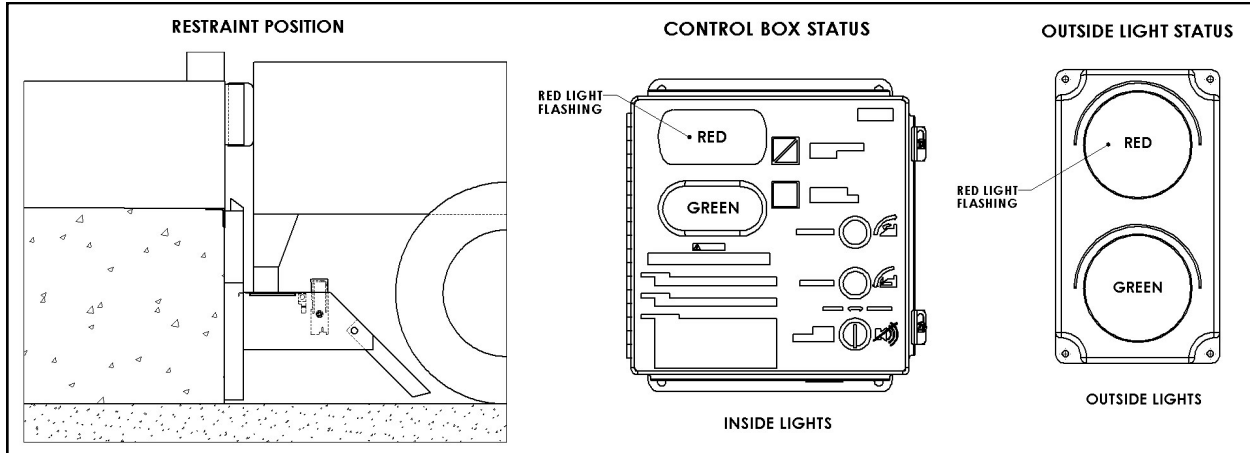

FIGURE C—RESTRAINT LOCKING

Restraint ENGAGED

Once the RIG is engaged by the barrier, an ENGAGED condition exists. Inside light is flashing green alerting the forklift operator a safe condition exists. Outside light is flashing red alerting truck driver not to move. Refer to Figure D.

WARNING

Visually inspect to ensure that the Lock-Up™ vehicle restraint barrier securely engages the RIG of the trailer before operating the dock leveler.

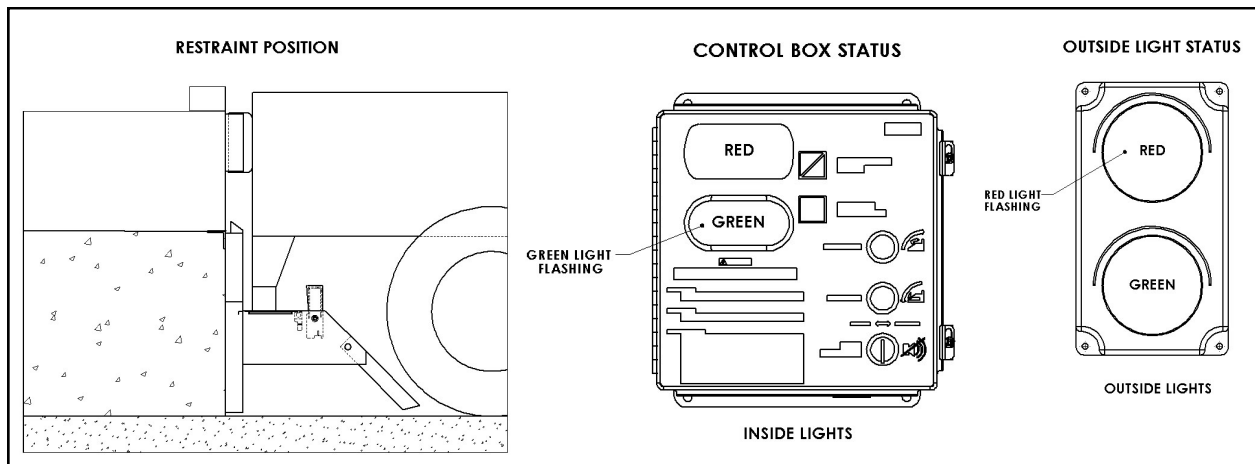

FIGURE D—RESTRAINT LOCKED

OPERATING PROCEDURE *continued*

RELEASE Button Pressed- Restraint DISENGAGING

Barrier travels from the ENGAGED position to the STORED position. Outside light is flashing red alerting truck driver not to move. Refer to Figure E.

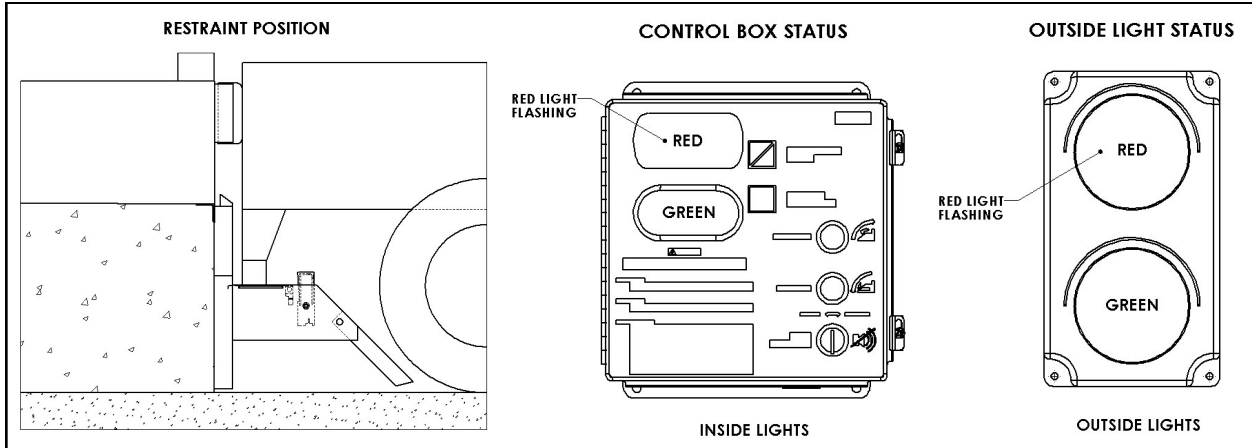

FIGURE E—RESTRAINT UNLOCKING

FAULT from ENGAGING State

Barrier cannot engage the RIG. This could be due to a RIG that is located too far toward the rear axle, bent, obstructed or missing. Inside light is flashing red and horn is pulsing, alerting the forklift operator that the trailer is not locked. Outside light is flashing red alerting the truck driver not to move. See Figure F.

If the trailer is parked firmly against the dock bumpers proceed to HORN OVERRIDE. If not, press RELEASE to clear the fault, have trailer back up and repeat Restraint ENGAGING.

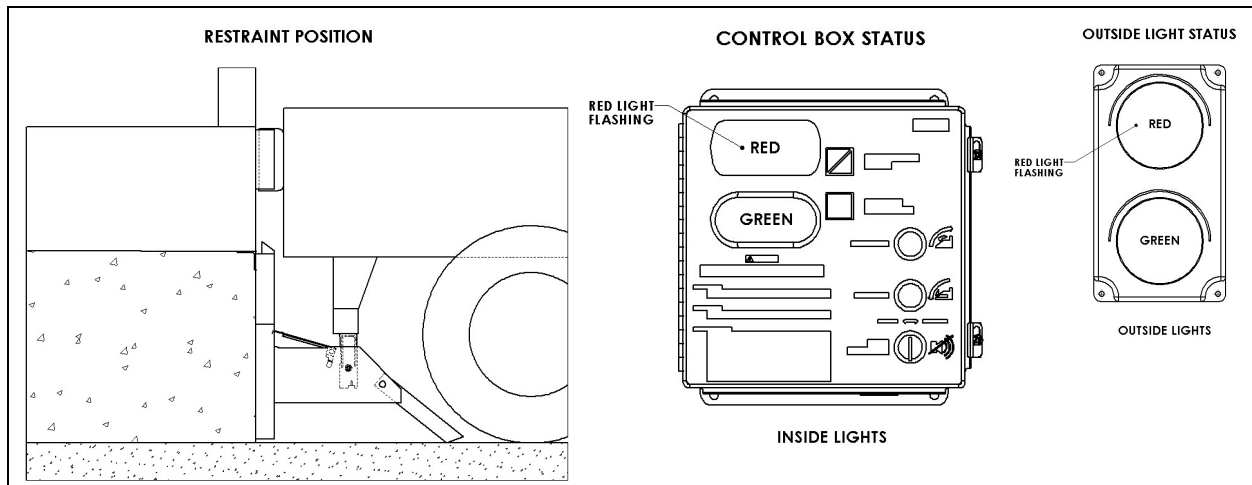

FIGURE F—FAULT STATE

OPERATING PROCEDURE *continued*

HORN OVERRIDE State, KEY SWITCH TURNED TO OVERRIDE after Securing Trailer by Alternate Means

An alternate means of securing the truck must be used (e.g. wheel chocks) if the barrier can not capture the RIG. Inside lights are flashing red and green alerting the forklift operator the trailer is secured by other means. Outside light is flashing red alerting the truck driver not to move. See Figure G.

To return to STORED, turn the HORN
OVERRIDE key and press the RELEASE button.

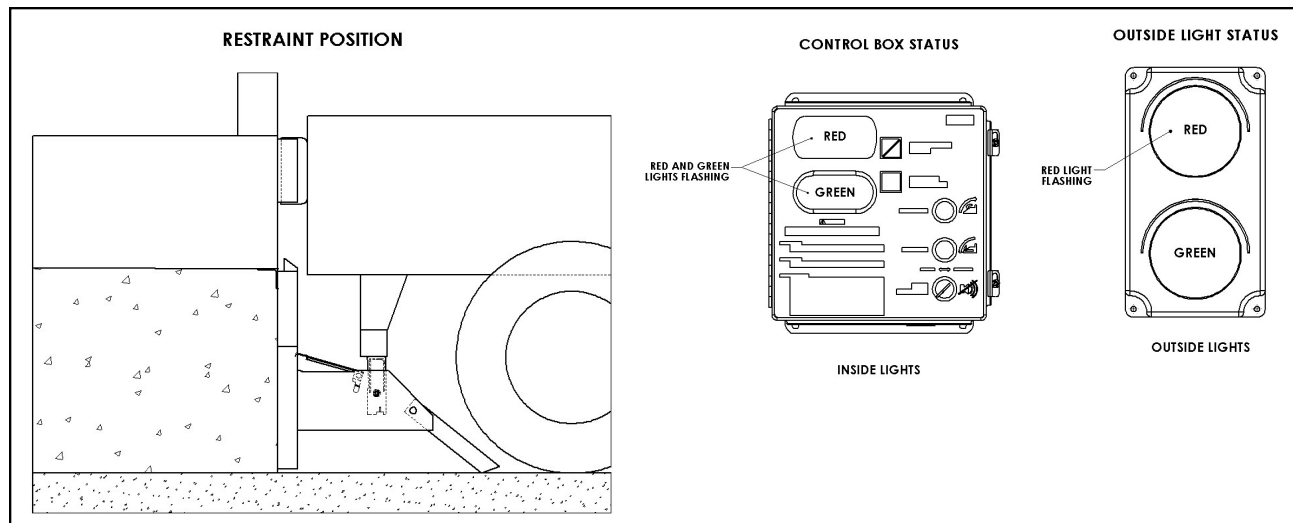

FIGURE G—HORN OVERRIDE STATE

ROUTINE MAINTENANCE



DANGER

When working with electrical or electronic controls, make sure that the power source has been locked out and tagged according to OSHA regulations and approved local electrical codes.

Post safety warnings and barricade work area, at dock level and at ground level, to prevent unauthorized use of the dock.



WARNING

Safe operation of the Lock-Up™ vehicle restraint requires all lights and the horn to be working properly. DO NOT use the Lock-Up™ vehicle restraint if parts are broken or missing.



CAUTION

Use lifting device (e.g. crane, jack) when lifting carriage (approx. 105 lbs.). Lifting by hand may cause back injury.

NOTICE

Maintenance may be required more frequently at loading docks exposed to harsh environments (extreme climates, corrosive chemicals, frequency of usage, etc.). If these conditions exist, consult NOVA for accelerated maintenance requirements.

NOTE: If a leveler is installed at the Lock-Up™ vehicle restraint location, it may be necessary to raise the leveler before performing maintenance. Raise the leveler, insert and secure the maintenance strut, and LOCKOUT/TAGOUT the power source.

In addition, it is recommended and good safety practice to use an additional means to support the dock platform and lip anytime when physically working in front of or under the dock leveler. This additional means may include, but not limited to a boom truck, fork truck, stabilizing bar or equivalent.

DAILY

- Remove debris around Lock-Up™ vehicle restraint.
- Verify that restraint operates smoothly and inside, outside lights and horn are working.
- Replace damaged or missing light bulbs and lenses.
- Repair, remount, or replace outside and inside signs and labels as required.
- Inspect dock bumpers. Missing bumpers must be replaced.

180 DAYS

- Perform all Daily maintenance.
- Grease rollers at fittings located on the top and bottom axle with a synthetic oil-base moly grease with a temperature range of -40° to 170° F.
- Inspect the outside electrical connections (junction box, conduit, power harness) and outside communication light. Loose or damaged components must be repaired or replaced.
- Check that all concrete anchor bolts are torqued to 100 ft-lbs.
- Perform operational test after all maintenance repairs and adjustments are complete.
- Inspect dock bumpers. Four inches (4") of protection is required. Worn, torn, loose or missing bumpers must be replaced.

360 DAYS

- Perform all Daily and 180 Day maintenance.

ROUTINE MAINTENANCE



DANGER

When working with electrical or electronic controls, make sure that the power source has been locked out and tagged according to OSHA regulations and approved local electrical codes.

The electrical control system for the Lock-Up™ converts the input from three position sensors into the output of two limit switches. This new system requires no maintenance.

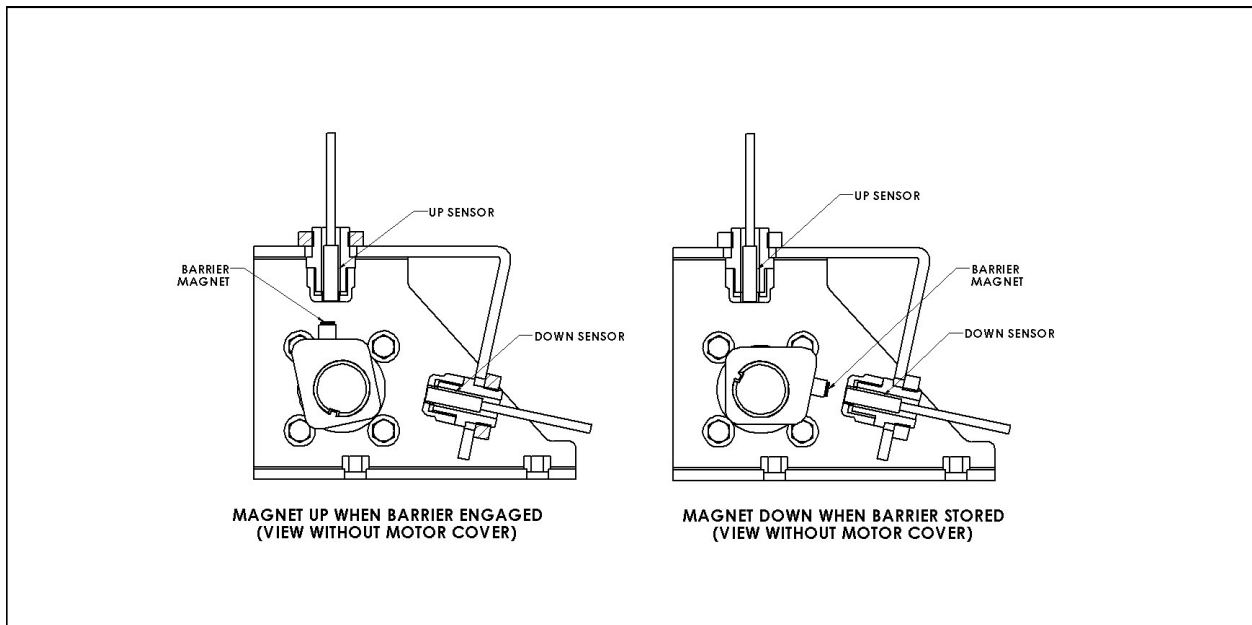

BARRIER SENSOR OPERATION

ROUTINE MAINTENANCE

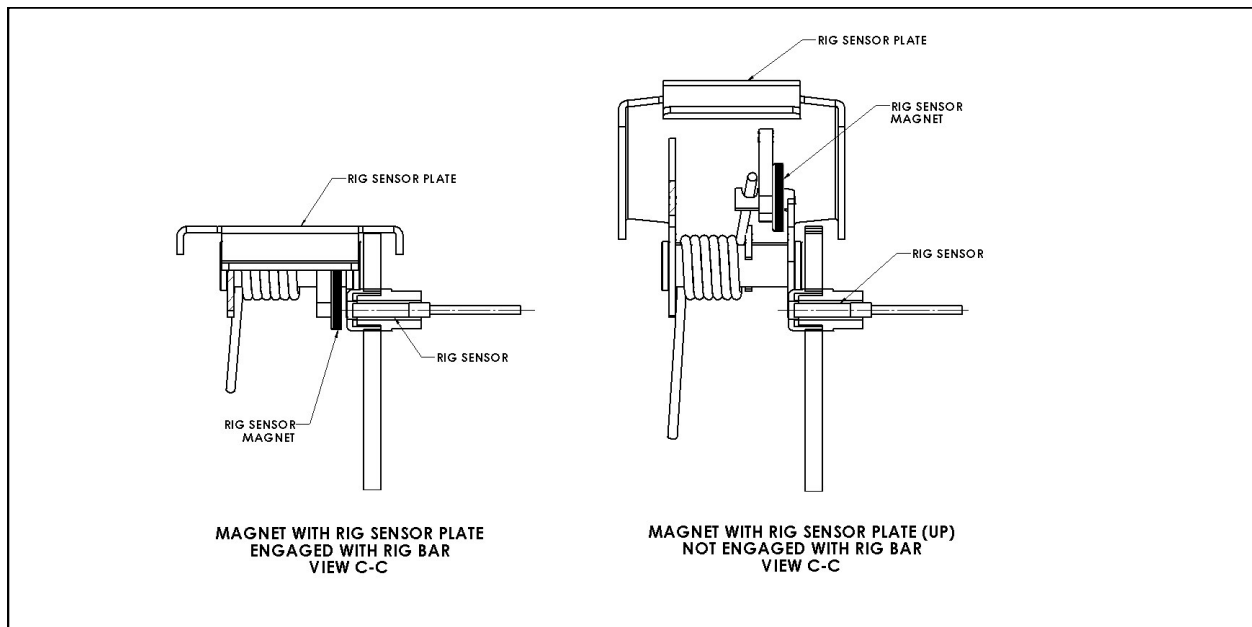
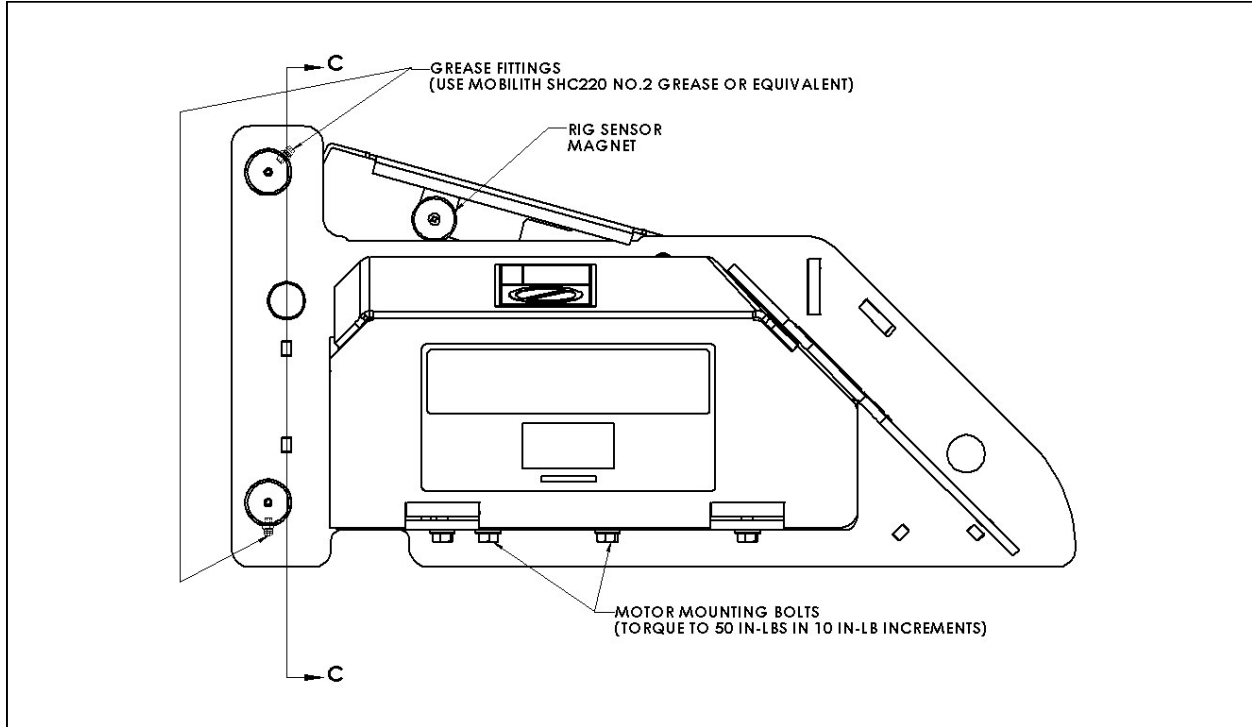

RIG SENSOR PLATE OPERATION

TROUBLESHOOTING

PROBLEM	PROBABLE CAUSE	RESOLUTION
Lock-Up™ vehicle restraint lights do not flash and the barrier does not raise.	<ul style="list-style-type: none"> • Power source malfunction. • Incorrect wiring. 	<ul style="list-style-type: none"> • Check power source, including facility circuit breaker and 1A fuse, and circuit breaker on power module. • Verify wiring per Electrical Schematic, Figure K page 14.
Lock-Up™ vehicle restraint lights are flashing, but the barrier does not raise or lower to full extent.	<ul style="list-style-type: none"> • Low incoming voltage. • Drive motor defective. • Incorrect wiring. 	<ul style="list-style-type: none"> • Verify incoming voltage at L1 and L2 is a minimum of 110V. Do not power off a control transformer from other equipment unless properly sized for load. • Check motor. Repair or replace as needed. • Verify wiring per Electrical Schematic, Figure K page 14.
Lock-Up™ vehicle restraint is operational but all lights are out.	<ul style="list-style-type: none"> • Bulbs burnt out, loose or missing. • Incorrect wiring. 	<ul style="list-style-type: none"> • Check all bulbs and replace as required. • Verify wiring per Electrical Schematic, Figure K page 14.
Lock-Up™ vehicle restraint horn does not sound but barrier and lights are operational.	<ul style="list-style-type: none"> • Horn is defective. • Incorrect wiring. 	<ul style="list-style-type: none"> • Power horn using 12V DC power. If horn does not sound, replace as required. • Verify wiring per Electrical Schematic, Figure K page 14.
Lock-Up™ vehicle restraint barrier is in stored position with an inside green light.	<ul style="list-style-type: none"> • Incorrect wiring. 	<ul style="list-style-type: none"> • Verify wiring of SW1 and SW2 at the control box and outside junction box.
Lock-Up™ vehicle restraint carriage does not return to a full up position	<ul style="list-style-type: none"> • Carriage binding in track. • Damaged roller track plate. • Broken or weak springs. 	<ul style="list-style-type: none"> • Check to see if roller track plate is clean and rollers are clean, full of debris and lubricated. Use only approved grease to lubricate rollers. • Verify that the roller track plate is straight and not damaged. • Remove spring cover and replace as required.

CONTROL HARNESS

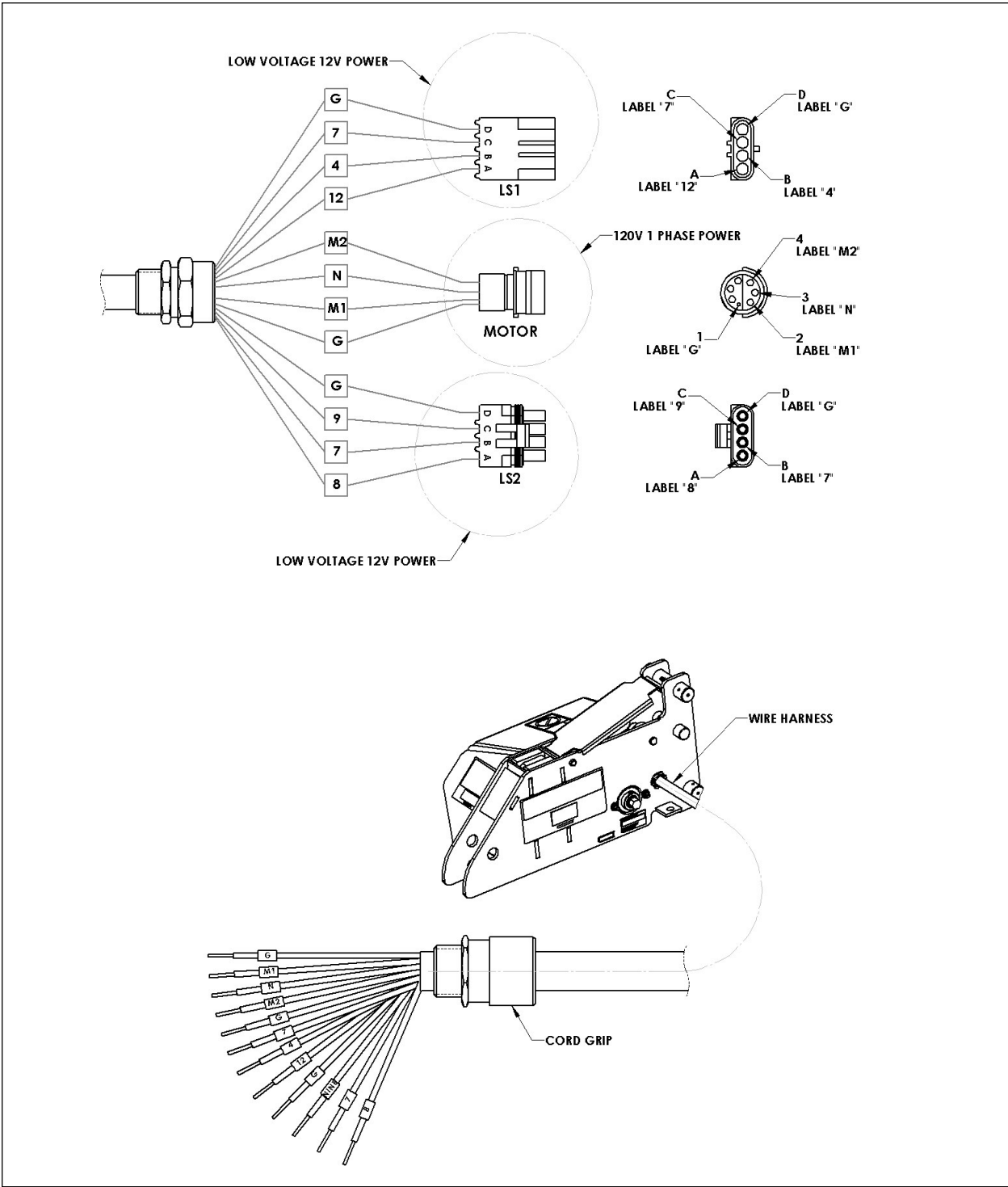
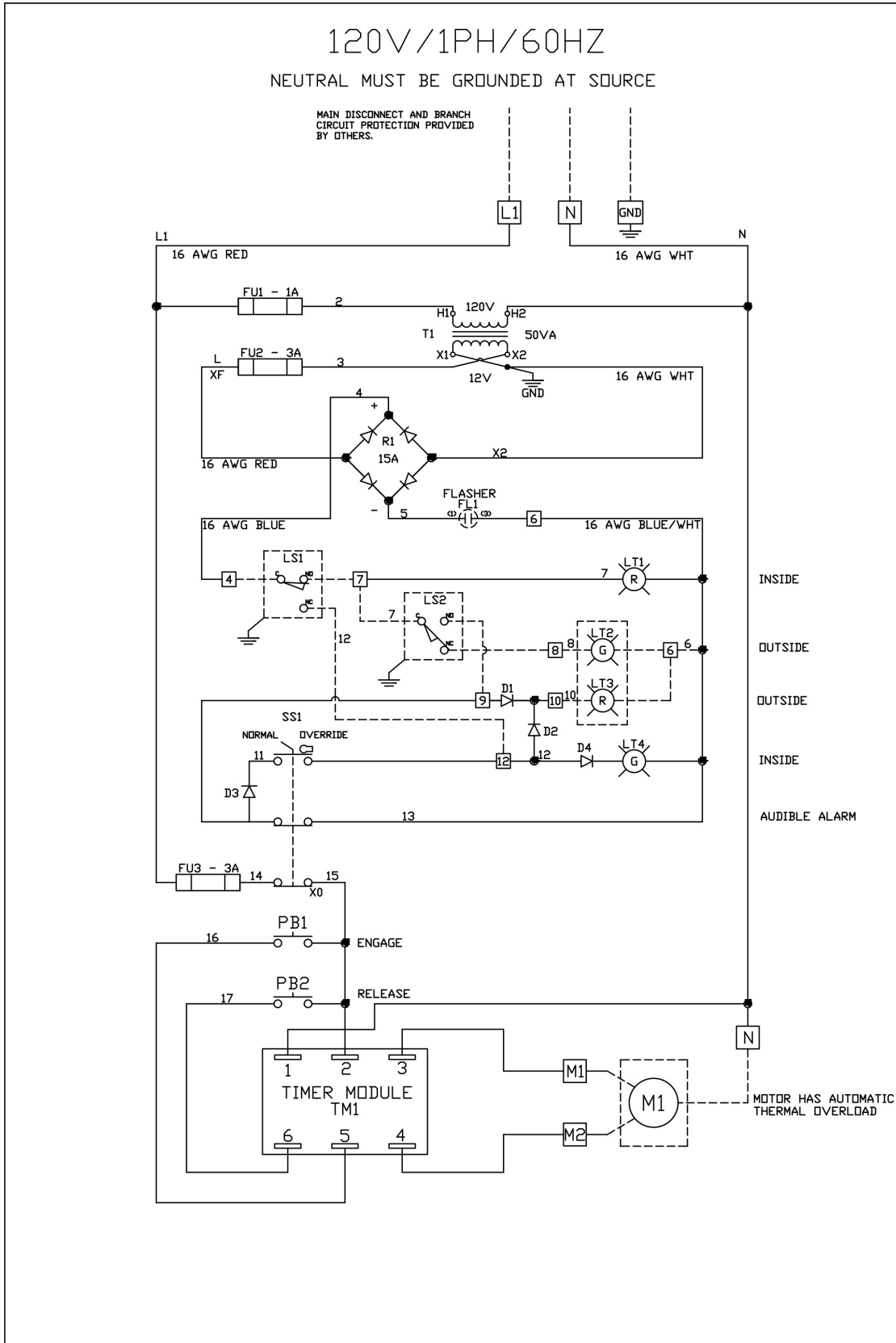

FIGURE J—CONTROL HARNESS

ELECTRICAL SCHEMATIC



OUTSIDE LIGHT BOX WIRING

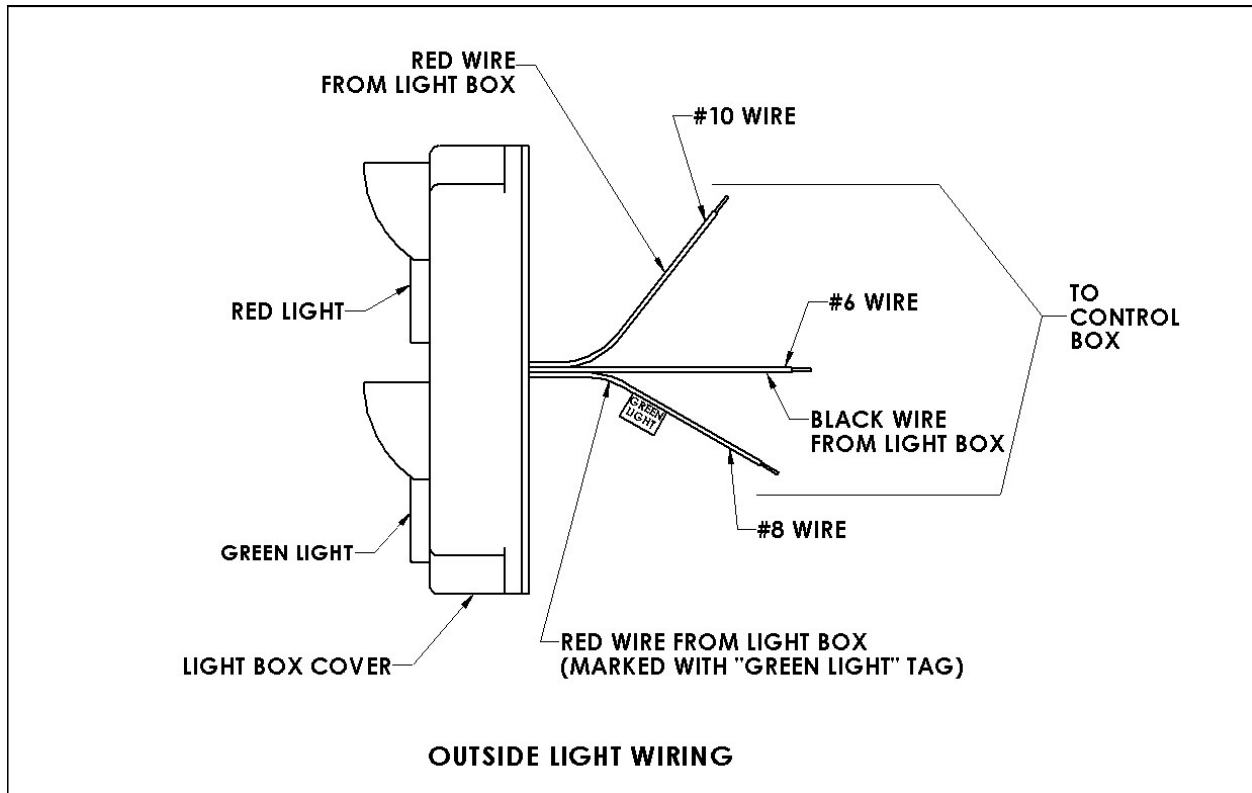

FIGURE L—OUTSIDE LIGHT BOX WIRING

PARTS

CARRIAGE ASSEMBLY DRAWING

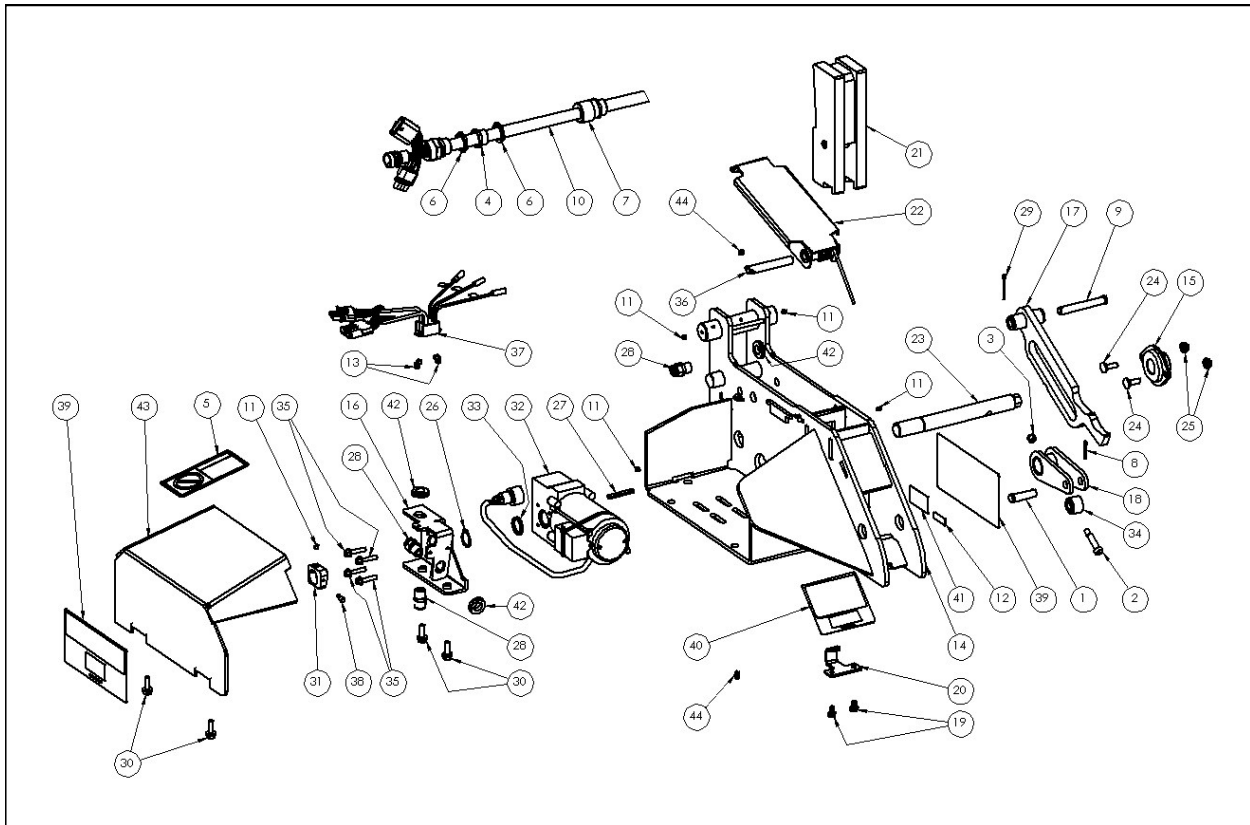

FIGURE M —CARRIAGE ASSEMBLY

CARRIAGE ASSEMBLY PARTS LIST

EM NO.	PART NUMBER	DESCRIPTION	QTY.
1	MF4-164-000	Ø1/2" X 1 3/4" LONG CLEVIS PIN	1
2	MF4-161-000	5/16-18 X 1 1/4" LONG SHOULDER SCREW	1
3	MF4-125-000	5/16-18 HEX NUT, NYLOK	1
4	MF2-034-000	3/4" CONDUIT NIPPLE	1
5	MF2-095-000	NO STEP DECAL	1
6	MF2-037-000	3/4" CONDUIT LOCK NUT	2
7	MF2-033-000	CORD GRIP	1
8	MF2-142-000	COTTER PIN	1
9	MF4-157-000	Ø1/2" X 3 1/2" CLEVIS PIN, ZINC	1
10	MF2-005-000	WIRE HARNESS	1

PARTS *continued*

CARRIAGE ASSEMBLY PARTS LIST *continued*

ITEM NO.	PART NUMBER	DESCRIPTION	QTY.
11	MF2-017-002	1/4-28 X 1/4" SOCKET SET SCREW	5
12	MF2-186-000	PATENT PENDING DECAL	1
13	MF2-187-000	ZIP TIE, 5.5" 40LB BLACK UV CABLE	2
14	MF4-100-000	MF4 CARRIAGE WELDMENT	1
15	MF4-101-000	STAMPED STEEL FLANGE MOUNTED BALL BEARING	1
16	MF4-103-000	MOTOR MOUNT BRACKET ASSEMBLY	1
17	MF4-104-000	LIFTER ARM ASSEMBLY	1
18	MF4-105-000	CRANK	1
19	MF4-106-000	1/4-20 X 1/2" LONG HEX HEAD SCR W/ EXTERNAL TOOTH LOCK WASHER	2
20	MF4-107-000	BARRIER RETAINER	1
21	MF4-108-000	BARRIER ASSEMBLY	1
22	MF4-110-000	RIG SENSOR ASSEMBLY	1
23	MF4-115-000	DRIVE SHAFT	1
24	MF4-118-000	5/16-18 X 1" LONG CARRIAGE BOLT	2
25	MF4-119-000	5/16-18 SERRATED FLANGE NUT	2
26	MF4-120-000	EXTERNAL RETAINING RING FOR Ø1" OUTSIDE SHAFT	1
27	MF4-121-000	□3/16" KEY	1
28	MF4-123-000	3/8" NPT CORD GRIP	3
29	MF4-124-000	COTTER PIN, ZINC	1
30	MF4-126-000	5/16-18 X 7/8" FLANGE HEAD SCREW	4
31	MF4-127-000	MAGNET MOUNT	1
32	MF4-129-000	MF4 MOTOR	1
33	MF4-137-000	SPACER, DRIVE SHAFT TO MOTOR	1
34	MF4-139-000	ROLLER ASSEMBLY	1
35	MF4-143-000	1/4-20 X 1 1/4" LONG FLANGE HEAD CAP SCREW	4
36	MF4-144-000	RIG SENSOR PIN ASSEMBLY	1
37	MF4-145-000	CABLE BOX ASSEMBLY	1
38	MF4-146-000	ACTUATOR MAGNET	1
39	MF4-148-000	"NOVA LOCK-UP" HORIZONTAL DECAL	2
40	MF4-149-000	"NOVA LOCK-UP" SQUARE DECAL	1
41	MF4-151-000	SERIAL NUMBER DECAL	1
42	MF4-160-000	CORD GRIP BULKHEAD NUT	3
43	MF4-165-000	MOTOR/CHAIN COVER	1
44	MF2-013-000	GREASE FITTING	2

PARTS *continued*

ROLLER TRACK ASSEMBLY DRAWING and PARTS LIST

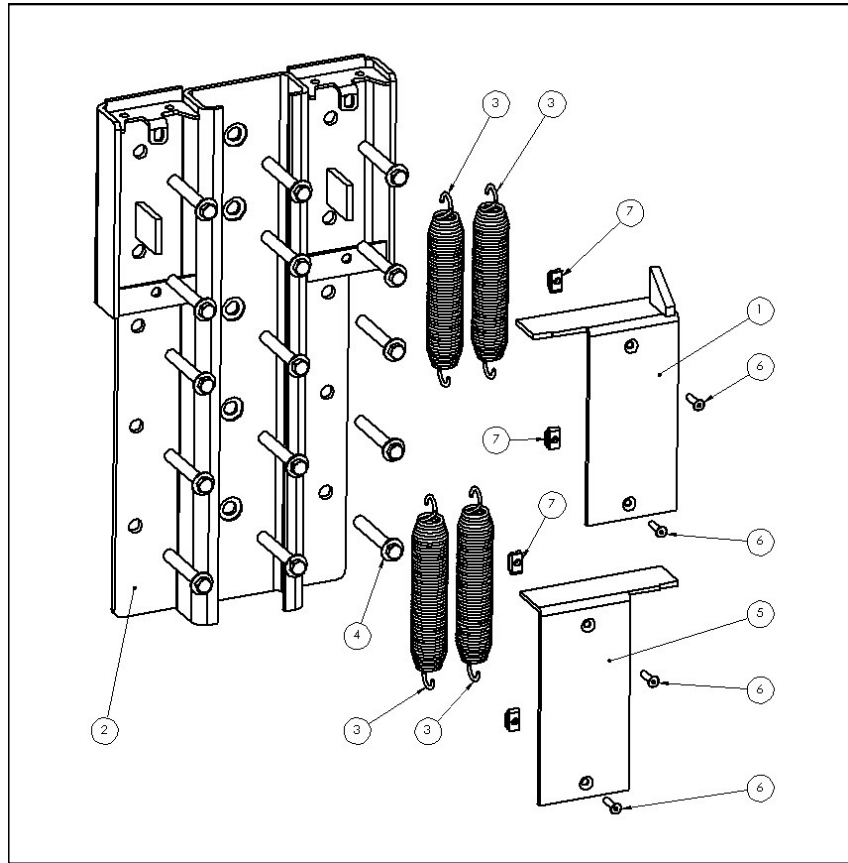

FIGURE N—ROLLER TRACK ASSEMBLY

ITEM NO.	PART NUMBER	DESCRIPTION	QTY.
1	MF2-052-000	SPRING COVER RIGHT HAND	1
2	MF2-048-000	ROLLER TRACK	1
3	MF2-050-000	EXTENSION SPRING	4
4	MF2-054-000	5/8 X 4" CONCRETE ANCHOR	15
5	MF2-051-000	LEFT SPRING COVER	1
6	MF2-060-000	5/16-18 X 1 1/4" FLAT HEAD SOCKET SCREW	4
7	MF2-192-000	5/16-18 U-STYLE CAGE NUT	4

PARTS *continued*

SLOPE EXTENSION DRAWING AND PARTS LIST

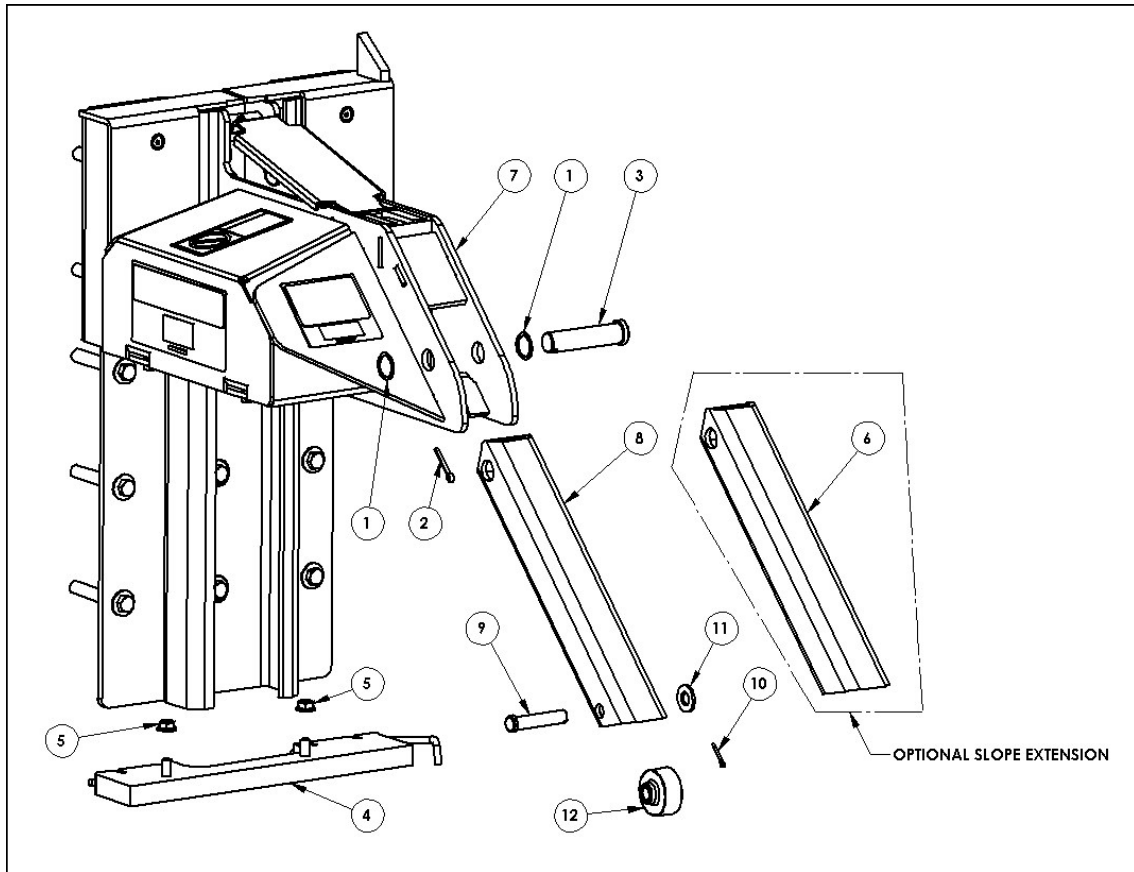

FIGURE O—SLOPE EXTENSION ASSEMBLY

ITEM NO.	PART NUMBER	DESCRIPTION	QTY.
1	MF2-045-000	1" X 18 GAUGE FLAT WASHER	2
2	MF2-046-000	COTTER PIN	1
3	MF2-044-000	SLOPE EXTENSION PIVOT PIN	1
4	MF2-043-000	SPRING MOUNTING PLATE ASSEMBLY	1
5	MF2-026-000	7/16-14 SERRATED FLANGE LOCK NUT	2
6	MF2-002-000	SLOPE EXTENSION	1
7	MF4-136-000	CARRIAGE ASSEMBLY	1
8	MF2-132-000	ROLLER SLOPE EXTENSION	1
9	MF2-143-000	Ø5/8" X 3" CLEVIS PIN	1
10	MF2-142-000	COTTER PIN	1
11	MF2-130-000	5/8" SAE FLAT WASHER	1
12	MF2-136-000	ROLLER ASSEMBLY	1

PARTS *continued*

ELECTRICAL PARTS

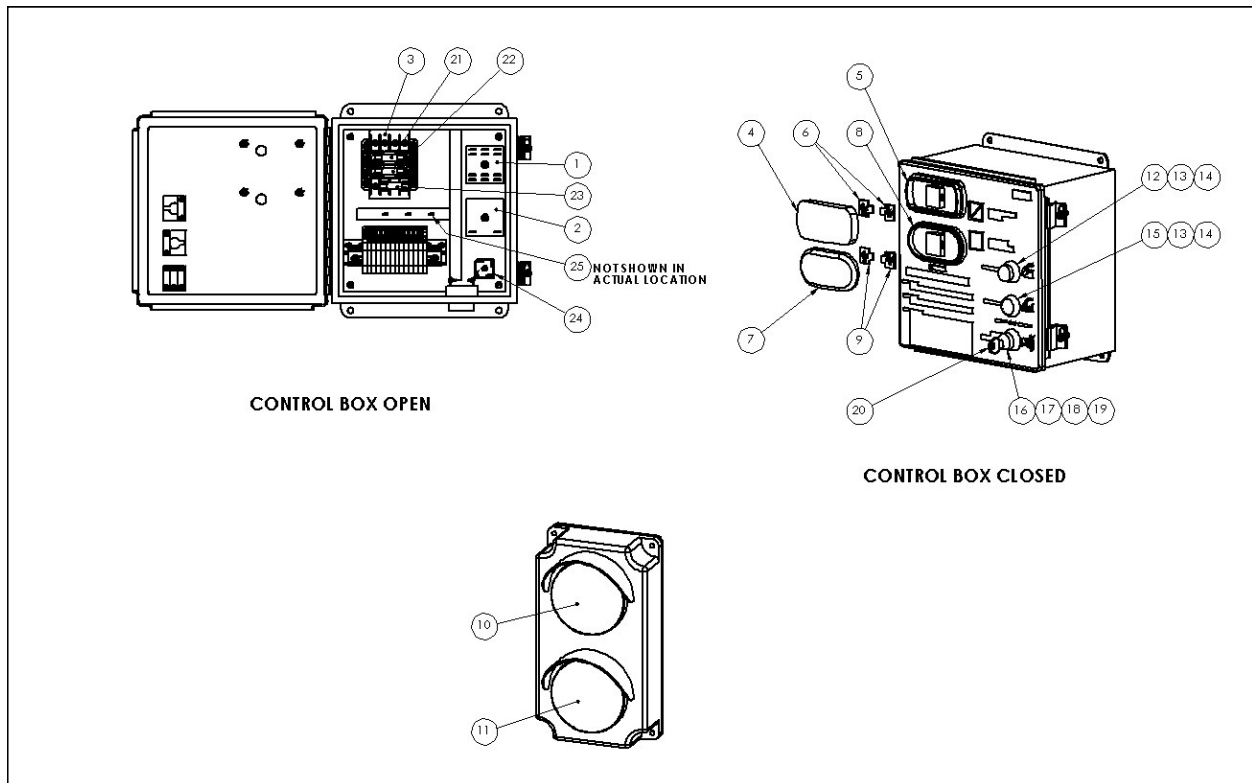

FIGURE P —ELECTRICAL PARTS

PARTS *continued*

ELECTRICAL REPLACEMENT PARTS LIST

ITEM NO.	PART NUMBER	DESCRIPTION	QTY.
1	MF2-082-000	TIMER	1
2	MF2-083-000	FLASHER	1
3	MF2-084-000	TRANSFORMER	1
4	MF2-085-001	RED RECTANGULAR LENS	1
5	MF2-085-002	RECTANGLE BASE	1
6	MF2-085-003	RED LED WEDGE	2
7	MF2-086-001	GREEN OVAL LENS	1
8	MF2-086-002	OVAL BASE	1
9	MF2-086-003	GREEN LED WEDGE	2
10	MF2-087-000	OUTSIDE RED LED LIGHT MODULE	1
11	MF2-088-000	OUTSIDE GREEN LED LIGHT MODULE	1
12	MF2-089-001	GREEN PUSH BUTTON	1
13	MF2-089-002	NO CONTACT	2
14	MF2-089-003	CONTACT BASE	2
15	MF2-090-001	YELLOW PUSH BUTTON	1
16	MF2-091-001	KEY SWITCH	1
17	MF2-091-002	NC CONTACT	1
18	MF2-091-003	NO CONTACT	1
19	MF2-091-004	CONTACT BASE	1
20	MF2-092-000	KEY	1
21	MF2-156-000	FUSE	1
22	MF2-157-000	FUSE	1
23	MF2-158-000	FUSE	1
24	MF2-191-000	BRIDGE RECTIFIER	1
25	MF2-193-000	DIODE	3

PARTS *continued*

MISCELLANEOUS PARTS

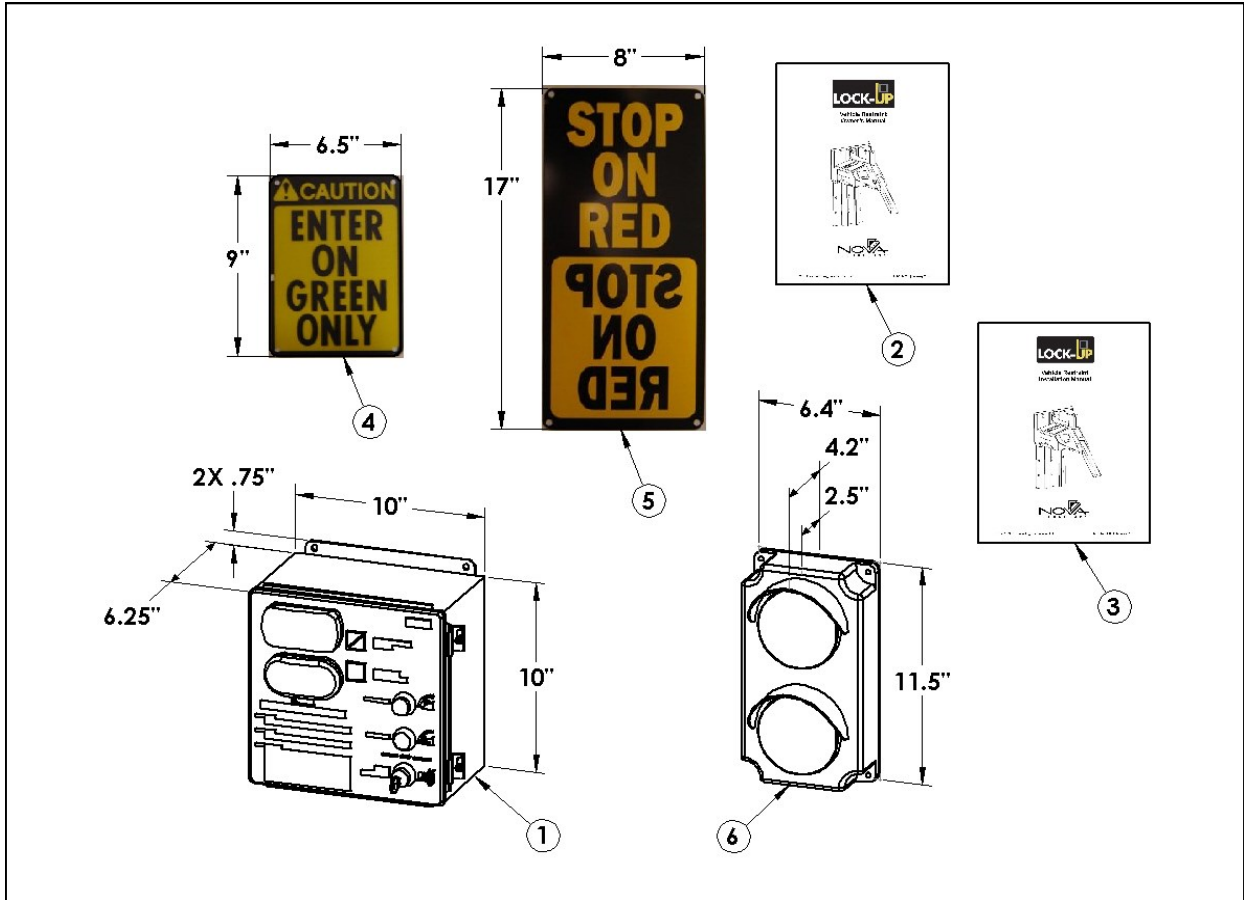

FIGURE Q —MISCELLANEOUS PARTS

MISCELLANEOUS REPLACEMENT PARTS LIST

ITEM NO.	PART NUMBER	DESCRIPTION	QTY.
1	MF2-011-000	CONTROL BOX	1
2	MF4-159-000	OWNERS MANUAL	1
3	MF4-158-000	INSTALLATION MANUAL	1
4	MF2-057-000	CAUTION SIGN	1
5	MF2-056-000	STOP ON RED SIGN	1
6	MF2-055-000	OUTSIDE TRUCK LIGHT ASSEMBLY	1

WARRANTY

NOVA STANDARD PRODUCT WARRANTY

Nova Technology International, LLC (“Nova”) warrants that its products will be free from defects in design, materials and workmanship for a period of one (1) year from the date of shipment. All claims for breach of this warranty must be made within 30 days after the defect is or can with reasonable care, be detected. In no event shall any claim be made more than 30 days after this warranty has expired. In order to be entitled to the benefits of this warranty, the product must have been properly installed, maintained and operated in accordance with all manufacturer’s recommendations and/or specified design parameters and not otherwise have been subject to abuse, misuse, misapplication, acts of nature, overloading, unauthorized repair or modification, application in a corrosive environment or lack of maintenance. Periodic lubrication, adjustment and inspection in accordance with all manufacturers’ recommendations are the sole responsibility of the Owner/User.

In the event of a defect, as determined by Nova, covered by this warranty, Nova shall remedy such defect by repairing or replacing any defective equipment or parts, bearing the cost for the parts, labor and transportation. This shall be exclusive remedy for all claims whether based on contract, negligence or strict liability.

PRODUCT SPECIFIC WARRANTY Lock-Up™ Vehicle Restraint

In addition to the “Standard Product Warranty” provided with all Nova Products, Nova guarantees materials, components and workmanship to be free of defects for the following extended periods:

- Extended 2-year General Warranty—for a period of two (2) years from date of shipment, this warranty specifically applies to; the roller track assembly, carriage assembly, RIG sensor assembly and control box only.
- Extended 5-year Structural Warranty—for a period of five (5) years from the date of shipment, product will carry a prorated structural warranty. This warranty specifically applies to; the roller track, carriage weldment, motor cover, barrier assembly and lower spring bar only.

NOT COVERED UNDER WARRANTY

- Routine maintenance, lubrication, adjustments, including initial field set-up.
- Repairs required as a result of failure to follow routine maintenance procedures specified in the owner’s manual, abuse, accident, willful damage, neglect, improper installation, submersion, or shipping damage.

WARRANTY LIMITATIONS

The above warranties are in lieu of any other warranties, whether expressed or implied, including but not limited to and implied warranty of merchantability for a particular purpose. Nova and its subsidiaries shall not in any event be liable to anyone, including third parties, for incidental, consequential or special damages of any kind including but not limited to, breach of warranty, loss of use, loss of profit, interruption of business or loss of goodwill.



N90W14507 Commerce Drive Menomonee Falls, WI 53051
Phone 262-502-1591 | 800-236-7325 | fax 262-502-1511
www.novalocks.com